

4

3

2

1

REVISIONS

ECO #	REV	DESCRIPTION	DATE	APPROVED
7332	A	INITIAL RELEASE	10/13/15	J. KORDIK
8760	B	REDRAWN IN SOLIDWORKS	4/8/22	L. LIU
8775	C	REVISED SHEET FORMAT	4/19/22	L. LIU

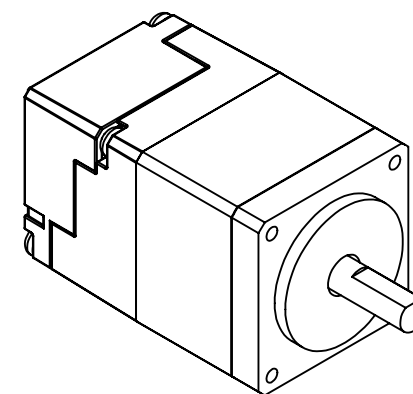
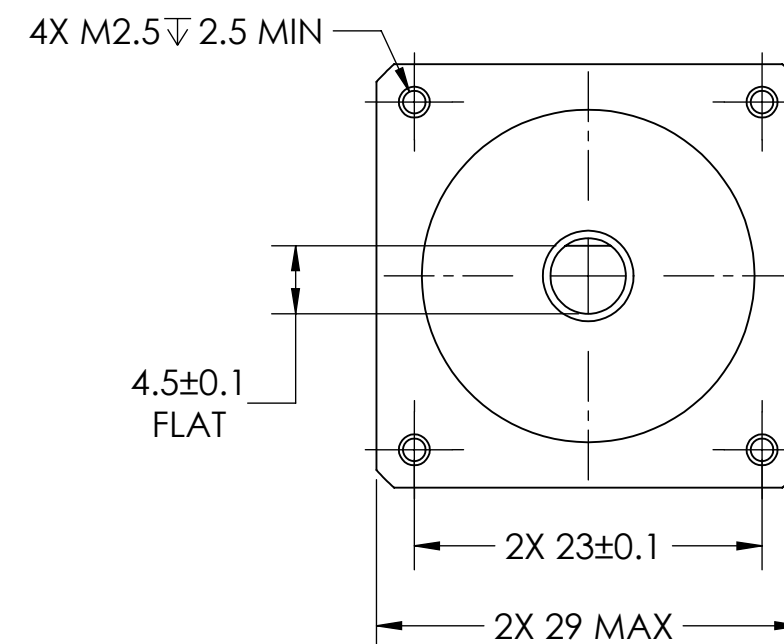
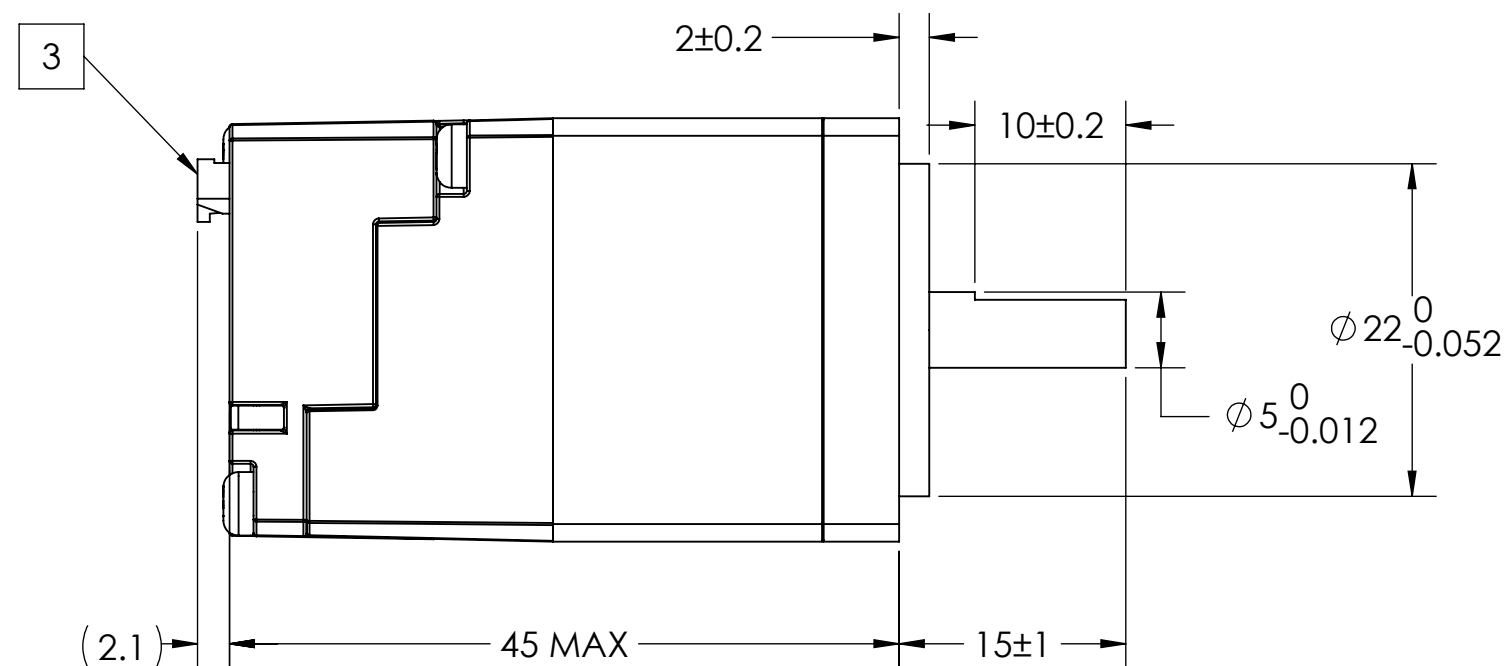

SPECIFICATIONS

INPUT VOLTAGE	15 TO 30 VDC	HOLDING TORQUE	0.065N · m
STEP ANGLE	1.8°	MAX AXIAL LOAD	4N [2]
STEP ACCURACY	±0.09°	MAX RADIAL LOAD	30N [2]
OPERATING TEMP	0 TO 40°C	RADIAL PLAY	0.02mm MAX (500gf RADIAL LOAD)
STORAGE TEMP	-20 TO 50°C	END PLAY	0.08mm MAX (500gf AXIAL LOAD)
TEMP RISE	80°C MAX	SHAFT RUNOUT	0.05mm T.I.R. MAX
ROTOR INERTIA	8.97g · cm ²	WEIGHT ± 10g	119g
IP RATING	IP20	APPROVALS	CE, RoHS

NOTES:

- REFER TO PRODUCT HARDWARE MANUAL ON APPLIED-MOTION.COM FOR MORE DETAILS.
- SHAFT LOADS FOR LIFE OF 20,000 HOURS AT 1000 RPM. RADIAL LOAD AT END OF SHAFT.
- CONNECTOR FOR POWER, I/O AND COMMUNICATION. USE INCLUDED CABLE 3004-319.

<p>Applied Motion Products A MOONS' COMPANY PROPRIETARY AND CONFIDENTIAL</p> <p>THE INFORMATION CONTAINED IN THIS DRAWING IS THE SOLE PROPERTY OF APPLIED MOTION PRODUCTS. ANY REPRODUCTION IN PART OR AS A WHOLE WITHOUT THE WRITTEN PERMISSION OF APPLIED MOTION PRODUCTS IS PROHIBITED.</p>	THIRD ANGLE PROJECTION	NAME	DATE	TITLE:		
	UNLESS OTHERWISE SPECIFIED: DIMENSIONS ARE IN MILLIMETERS	DRAWN	Y. LAPNET	4/19/22	INTEGRATED STEP-SERVO MOTOR	
	TOLERANCES: - ANGULAR: ± 0.5 - ONE DECIMAL PLACE: ± 0.25 - TWO DECIMAL PLACES: ± 0.13	PRE.CHECK			SIZE	DWG. NO.
	MATERIAL	FIN.CHECK	C. BREUNINGER	4/19/22	B	TSM11-1RM
	FINISH	SAP: 4696351002073			REV	C
DO NOT SCALE DRAWING	ALT DWG. NO.:			SCALE: 1:1	SHEET 1 OF 1	

4

3

2

1